

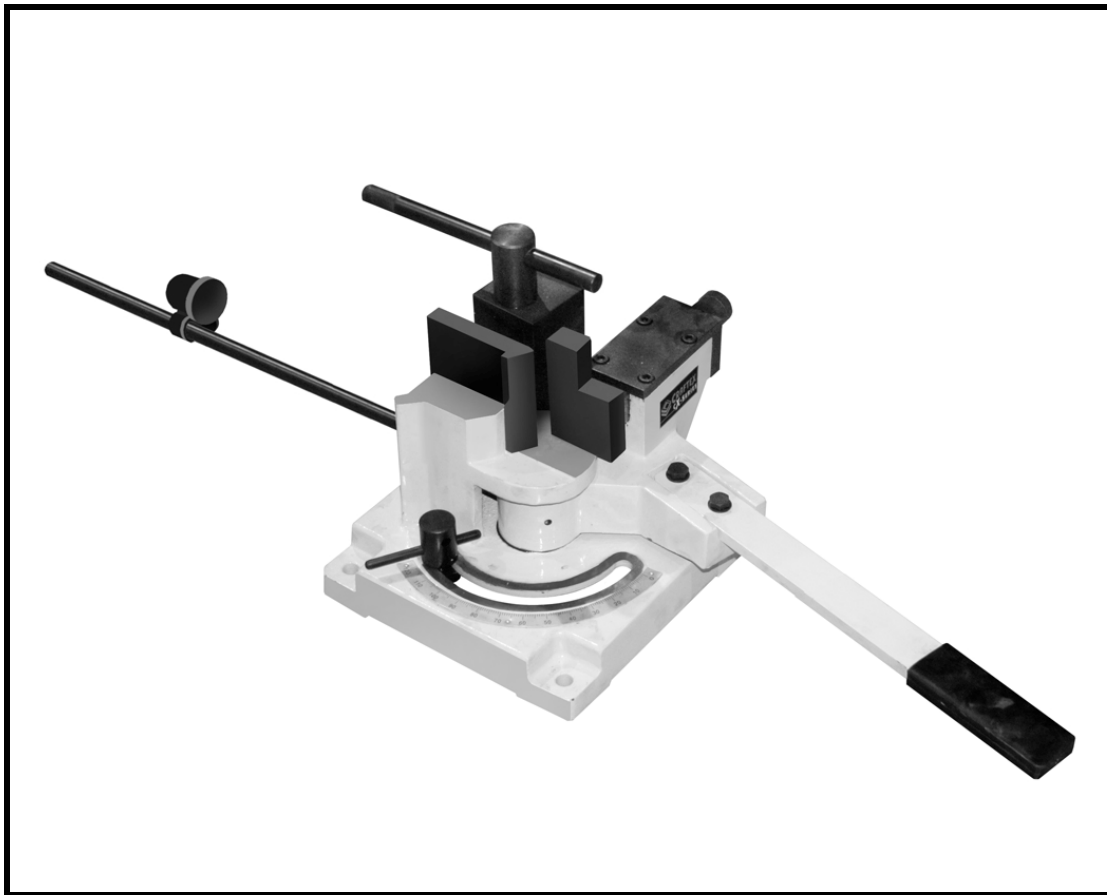

MODEL CX811 UNIVERSAL BENDER USER MANUAL

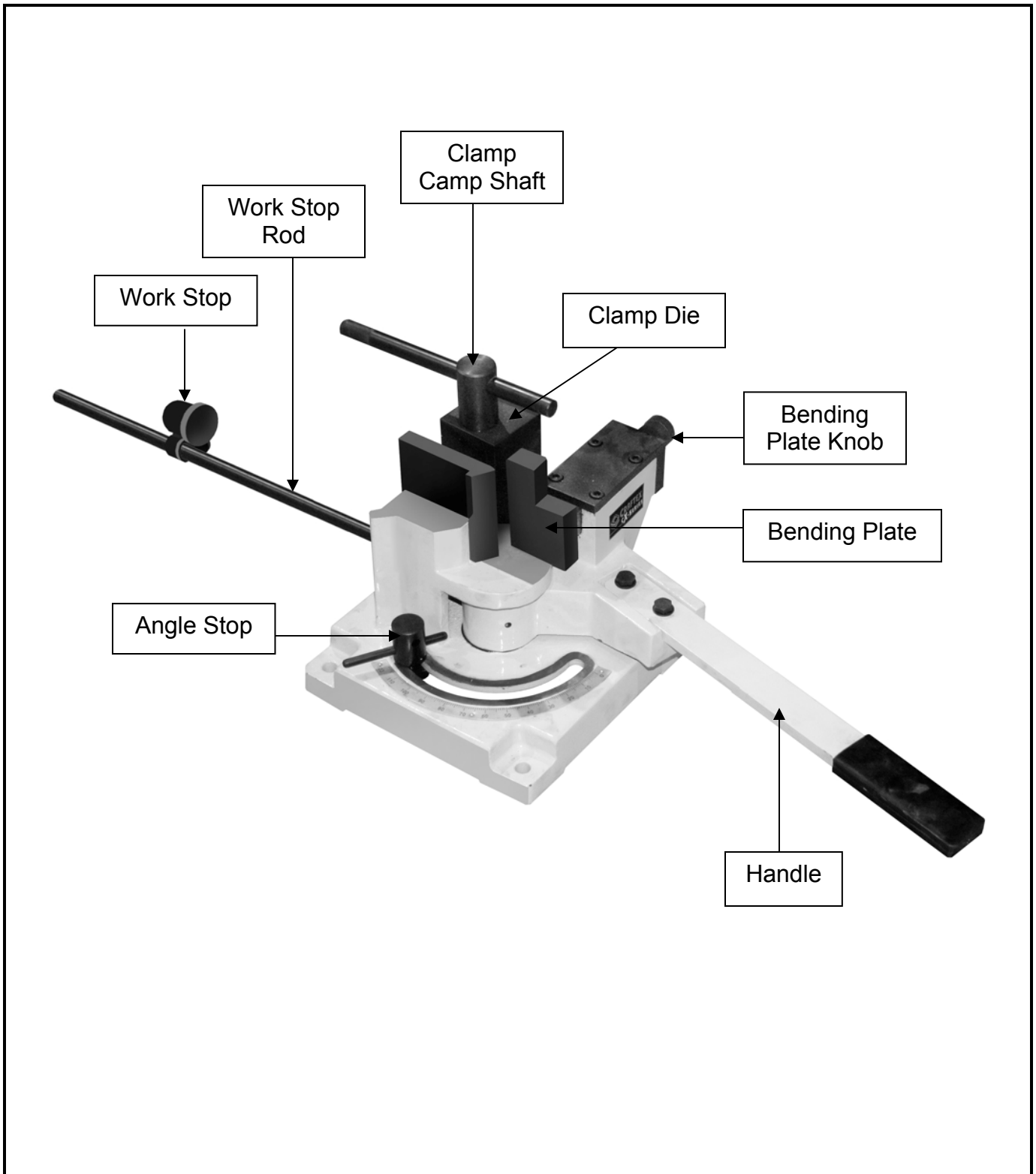

CX811 PHYSICAL FEATURES



UNPACKING

The CX811 is properly packaged in a carton for safe transportation. When unpacking, carefully inspect the carton and ensure that nothing has been damaged during transit.

INVENTORY

The bender consists of the following:

CONTENTS	QTY
A. Bender.....	1
B. Handle.....	1
C. Work Stop Rod.....	1
D. Hex Bolts.....	2
E. Flat Washers.....	2
F. Work Stop.....	1
G. Work Stop Knob.....	1
H. Hex Nut.....	1

While doing the inventory if you can not find any parts, check if the part is already installed on the bender.

ASSEMBLY

Attach the handle to the bender and secure it by using the hex bolts and flat washers provided. See figure-1.

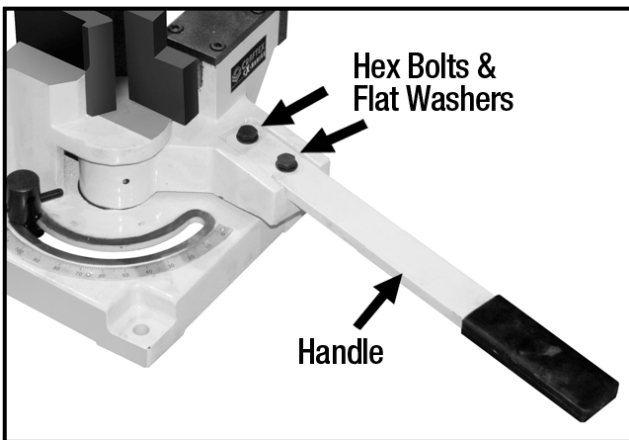

Figure-1 Installing the handle

Insert the stop rod into the base and tighten the hex nut against the base to secure it.

Slide the work stop onto the work stop rod and thread the knob onto the work stop to secure it to the rod.

MOUNTING

The bender features four pre-drilled holes on its base which allow mounting it to the workbench.

There are two ways to mount the bender onto the workbench; through mount and direct mount.

"Through Mount" is the strongest mounting option where the holes are drilled all the way through the workbench. Hex bolts, washers and hex nuts are used to secure the bender to the workbench. See figure-2.

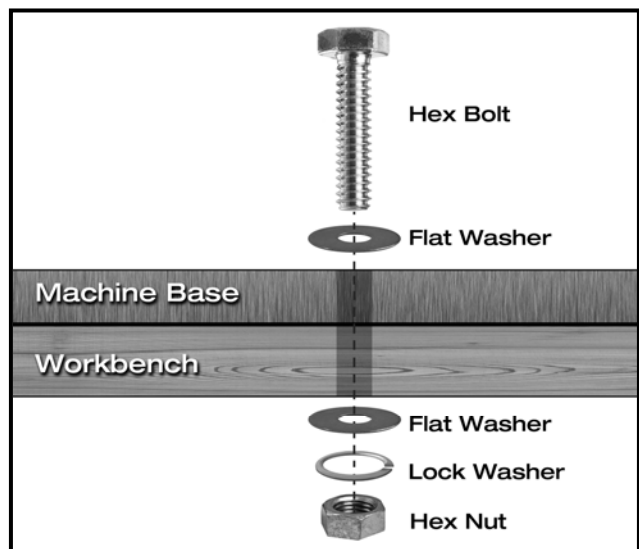

Figure-2 Through mount

"Direct Mount" is to simply secure the bender to the workbench using lag screws. See figure-3.

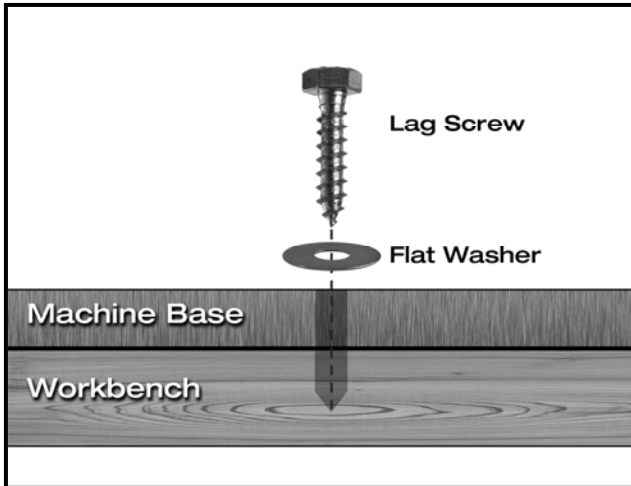

Figure-3 Direct mount

Place the bender on the workbench and use the holes on the base as a guide for drilling and attaching the bender to the workbench.

OPERATION

Lift the clamp cam shaft releasing the clamp die. Rotate the clamp die as required to accommodate the work-piece thickness and slide back the clamp cam shaft into position.

Place the work-piece into the clamp and rotate the cam shaft to clamp the work-piece.

Make sure the clamp is holding the work-piece properly. Adjust the bending plate to support the work-piece while bending.

Bend the work-piece to the desired angle using the handle.

Loosen the bending plate and clamp cam shaft to release the work-piece.

REPETITIVE BENDS

The CX811 comes with work stop and angle stop which allow user to accurately bend multiple work-pieces to the same angle.

To use the work stop and angle stop:

Position the work-piece into the bender and adjust the work stop against the end of the work-piece. Tighten the work stop knob.

Use the handle and bend the work-piece to the desired angle. Slide the angle stop against the bender base, turn the angle stop and lock it position.

When bending each new work-piece, position the work-piece against the work stop and clamp it. Use the handle to bend it until the moving bender base contacts the angle stop.

WARNING!

Do not force the machine to do the job, which it is not designed. Failure to do so could result damage to the machine.

CX811 - PARTS DIAGRAM AND PARTS LIST

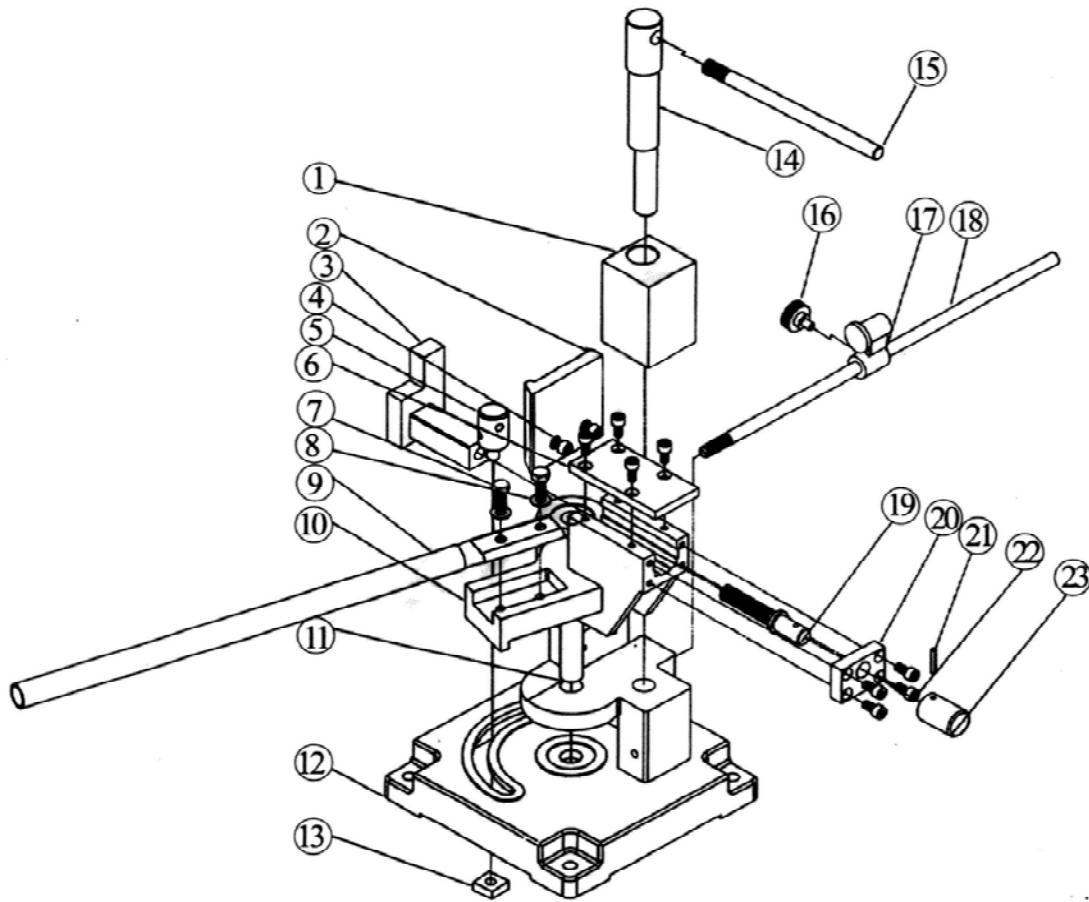

PART#	DESCRIPTION
1	CLAMP DIE
2	BENDING PLATE
3	SLIDING BLOCK
4	SCREW- M8 X 20
5	ANGLE STOP
6	PRESS PLATE
7	BOLT - M10 X 25
8	WASHER ϕ 10
9	HANDLE
10	ROTARY BLOCK
11	FIXED SHAFT
12	BASE

PART#	DESCRIPTION
13	NUT - SQUARE
14	CLAMP CAM SHAFT
15	SHAFT
16	NUT - HANDLE M8 X 15
17	WORK STOP
18	WORK STOP ROD
19	SCREW - SHAFT
20	COVER PLATE
21	PIN - SPRING 5 X 30
22	SCREW - M8 X 16
23	BENDING PLATE KNOB



WARRANTY

CRAFTEX 3 YEARS LIMITED WARRANTY

Craftex warrants every product to be free from defects in materials and agrees to correct such defects where applicable. This warranty covers **three years** for parts and 90 days for labour (unless specified otherwise), to the original purchaser from the date of purchase but does not apply to malfunctions arising directly or indirectly from misuse, abuse, improper installation or assembly, negligence, accidents, repairs or alterations or lack of maintenance.

Proof of purchase is necessary.

All warranty claims are subject to inspection of such products or part thereof and Craftex reserves the right to inspect any returned item before a refund or replacement may be issued.

This warranty shall not apply to consumable products such as blades, bits, belts, cutters, chisels, punches etceteras.

Craftex shall in no event be liable for injuries, accidental or otherwise, death to persons or damage to property or for incidental contingent, special or consequential damages arising from the use of our products.

RETURNS, REPAIRS AND REPLACEMENTS

To return, repair, or replace a Craftex product, you must visit the appropriate Busy Bee Tools showroom or call 1-800-461-BUSY. Craftex is a brand of equipment that is exclusive to Busy Bee Tools.

For replacement parts directly from Busy Bee Tools, for this machine, please call 1-800-461-BUSY (2879), and have your credit card and part number handy.

- All returned merchandise will be subject to a minimum charge of 15% for re-stocking and handling with the following qualifications.
- Returns must be pre-authorized by us in writing.
- We do not accept *collect* shipments.
- Items returned for warranty purposes must be insured and shipped pre-paid to the nearest warehouse
- Returns must be accompanied with a copy of your original invoice as proof of purchase. Returns must be in an un-used condition and shipped in their original packaging a letter explaining your reason for the return. Incurred shipping and handling charges are not refundable.
- Busy Bee will repair or replace the item at our discretion and subject to our inspection.
- Repaired or replaced items will be returned to you pre-paid by our choice of carriers.
- Busy Bee reserves the right to refuse reimbursement or repairs or replacement if a third party without our prior authorization has carried out repairs to the item.
- Repairs made by Busy Bee are warranted for 30 days on parts and labour.
- Any unforeseen repair charges will be reported to you for acceptance prior to making the repairs.
- The Busy Bee Parts & Service Departments are fully equipped to do repairs on all products purchased from us with the exception of some products that require the return to their authorized repair depots. A Busy Bee representative will provide you with the necessary information to have this done.
- For faster service it is advisable to contact the nearest Busy Bee location for parts availability prior to bringing your product in for repairs.