



# MODEL CX427

## Portable Cyclone Separator



**COPYRIGHT © 2021 BY CRAFTEX INDUSTRIES INC.**

NO PORTION OF THIS MANUAL MAY BE PRODUCED WITHOUT THE WRITTEN CONSENT OF CRAFTEX INDUSTRIES INC.



Version 1

# TABLE OF CONTENTS

Technical Specifications .....	3
Assembly Instructions .....	5
Operation .....	7
Cyclone Separator Parts Diagram.....	9
Warranty.....	11

## Technical Specifications CX427:

Drum Capacity.....	118L
Collection bag size.....	19.68" x 33.46"
Inlet size.....	5"
Inlet adaptor.....	1x5" - 2x4"
Outlet size.....	5"
Outlet adaptor.....	5" - 4"
Weight.....	24 Kg
Gross Weight.....	26.5 kg
Overall size.....	31"X20"X61"
Packing size.....	22" X 22" X 40"

### Introduction:

The Craftex Portable Cyclone Separator creates a cyclone of incoming air that effectively separates heavy wood chips as well as larger dust particles, helping to increase the efficiency of your single stage dust collection system. This will also result in less suction loss from dirty or clogged filters.

### Site Consideration:

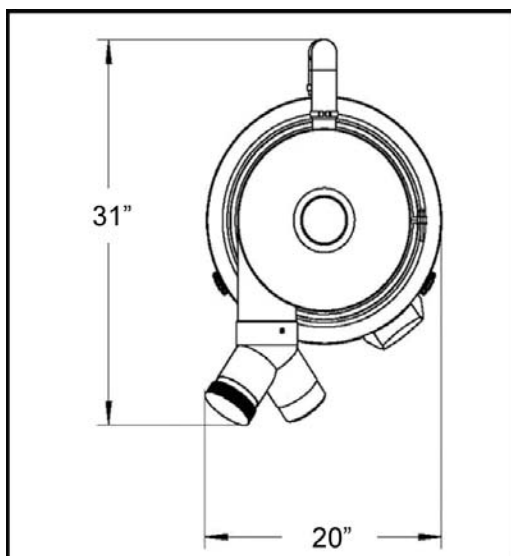

Figure 1

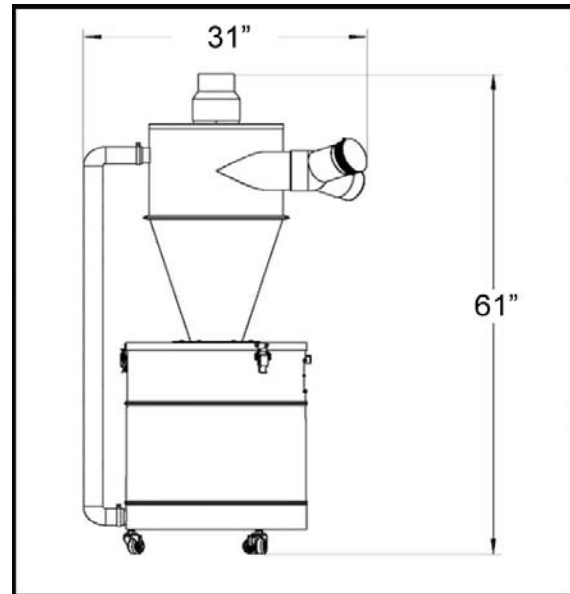

Figure 2

### Assembly

The cyclone separator is not pre-assembled. After unpacking, the machine must be assembled. Transport the interceptor in its packing crate to a place near its final installation site before unpacking it. If the packaging shows signs of possible transport damage, take the necessary precautions not to damage the machine when unpacking. If any damage is discovered, the carrier and/or shipper must be notified upon receipt of this fact immediately to establish any claim which might arise.

### Unpacking:

The following is a list of items shipped with your machine. Before beginning setup, lay these items out and inventory them.

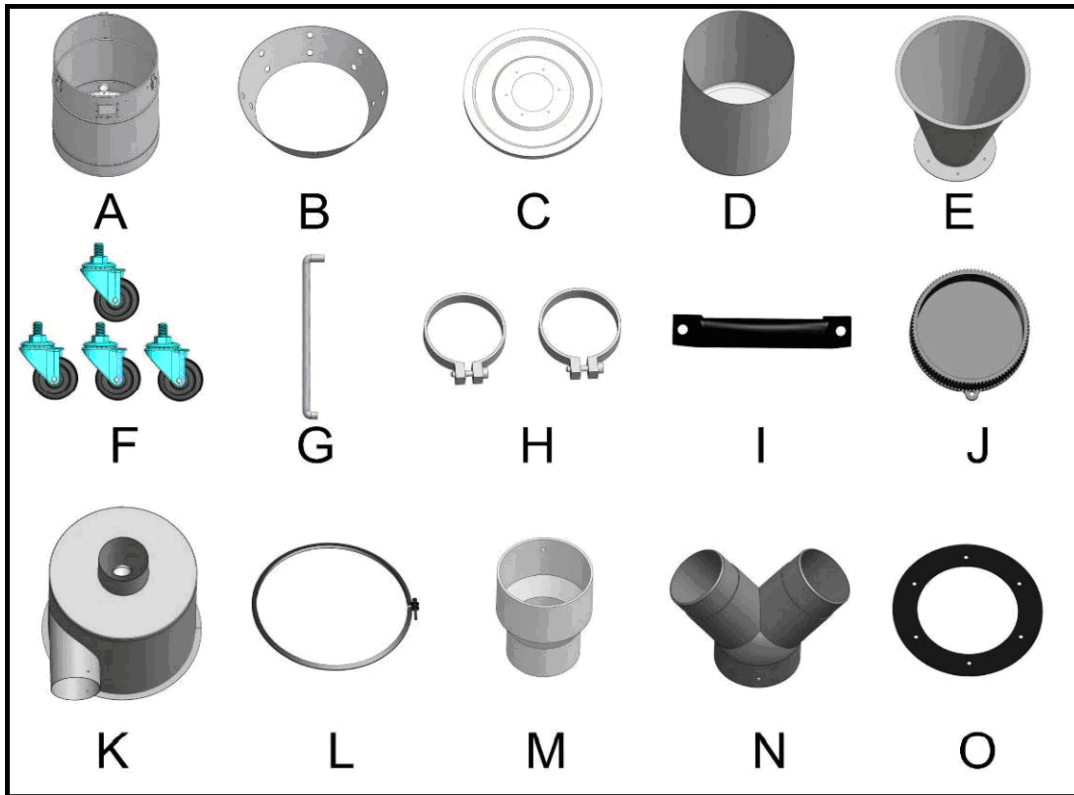

Figure 2

- A. Collection drum
- B. Vacuum ring
- C. Collection drum lid
- D. Collection bag
- E. Cyclone funnel
- F. Drum caster
- G. Vacuum hose
- H. Vacuum hose clamp
- I. Drum handle
- J. End cap
- K. Intake barrel
- L. Band clamp
- M. Outlet adaptor
- N. Inlet adaptor
- O. Rubber gasket

**Note:**

If you cannot find an item on this list, carefully check around/inside the machine and packaging materials. Often, these items get lost in packaging materials while unpacking or they are pre-installed at the factory.

### Assembly Instructions:

The cyclone separator must be fully assembled before it can be operated. Before beginning the assembly process, gather all listed items. To ensure the assembly process goes smoothly, first clean any parts that are covered or coated in heavy-duty rust preventative (if applicable).

1. Install the four drum casters with M10 nut on the bottom of the dust collection drum as shown in figure 3.



Figure 3

2. Install the drum handle on the collection drum with M8X20 bolt, flat washer 8 and M8 self-locking nut. (See figure 4)
3. Place vacuum ring inside collection drum with smaller side of ring facing down. (See figure 4)
4. Put the dust collection bag in the collection drum. (See figure 4)

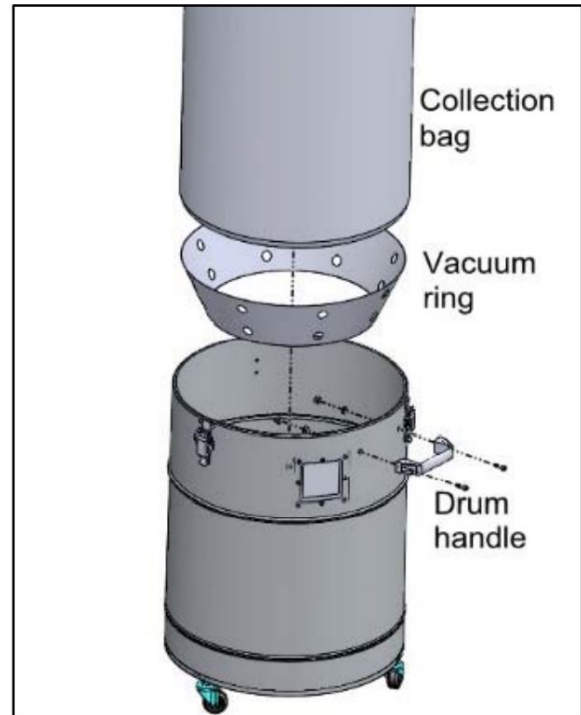

Figure 4

5. Add the rubber gasket between the cyclone funnel and the drum lid, fasten the three parts with M6X15 screws, flat washer and M6 nut. (See figure 5)
6. Set funnel and lid on collection drum and secure with latches. (See figure 5)

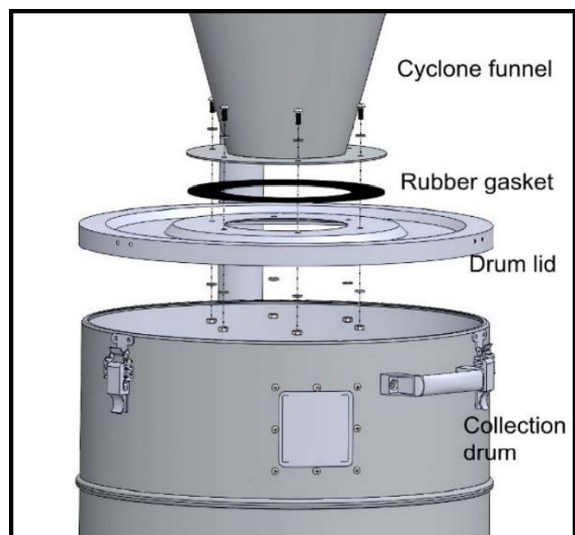
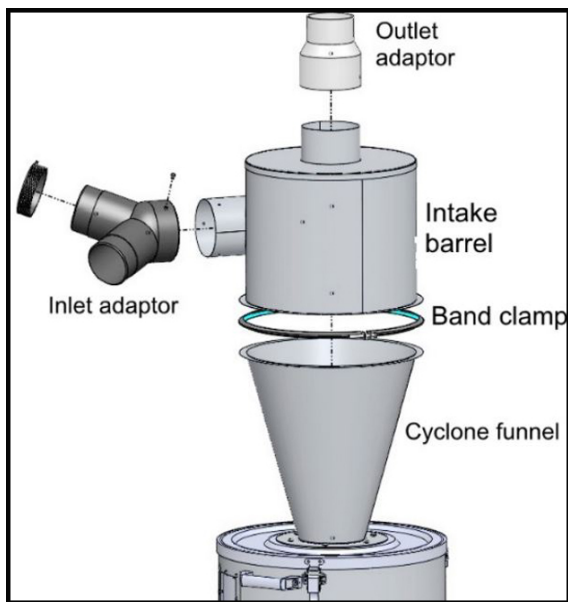

Figure 5

7. Place intake barrel on top of cyclone funnel, then apply band clamp on the cyclone funnel and intake barrel's lips to tighten and secure both. (See figure 6)
8. Install inlet adaptor on dust port and secure with M5X8 screw. Then fit the lid on the adaptor. (See figure 6)
9. Install outlet adaptor on intake barrel. (See figure 6)



**Figure 6**

10. Place hose clamps over ends of vacuum hose, then attach one end of vacuum hose to intake barrel and other end to collection drum. Tighten clamps to secure hose. (See figure 7)

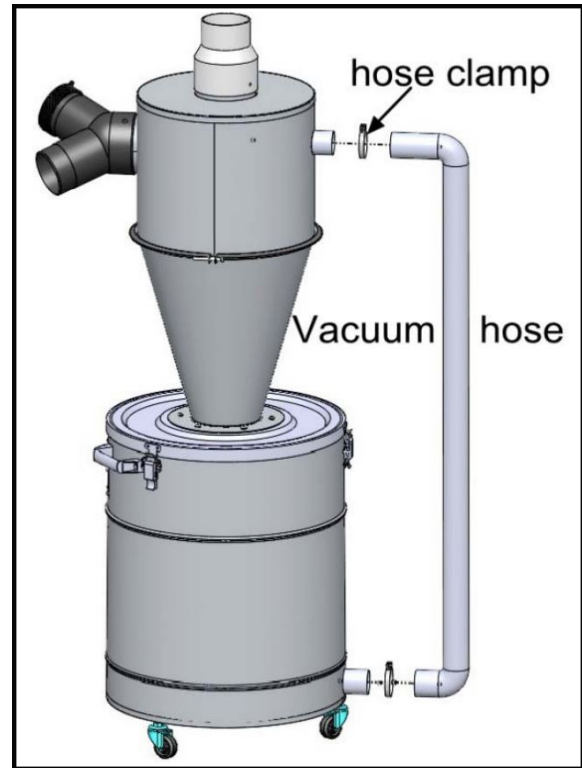

**Figure 7**

### **Understanding Your CX427 Cyclone Separator:**

CX427 is a stand-alone, unpowered, cyclone separator. It is designed to be used with a standard dust collector to provide the airflow. Using this separator, you can create a wood dust and chip collection system which handles both more efficiently. This cyclone separator creates a vortex of incoming air that extracts heavy wood chips and large dust particles, and then drops them into the collection drum only allowing the fine particulate to reach the dust collector. This is helpful so that the wood chips will not clog the intake of your dust collector and will be separately gathered in the drum. You can either use this unit to upgrade your current workshop dust collection system (with the typical bag or

canister filter) or place this unit next to a jointer or thickness planer to intercept and collect the wood chips and other large dust particles. (See figure 8)

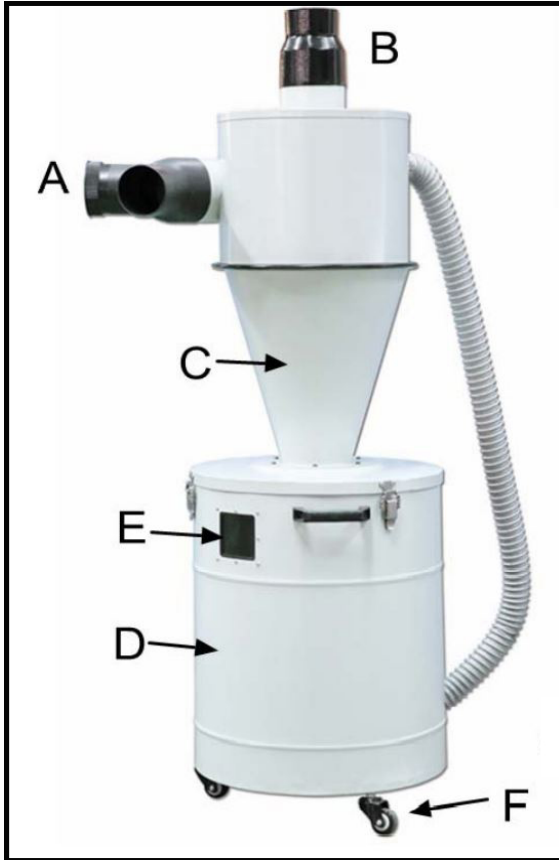

Figure 8

- A. Inlet adaptor 1x $\Phi$ 125mm-2x $\Phi$ 100mm
- B. Outlet adaptor  $\Phi$ 125mm- $\Phi$ 100mm
- C. Cyclone funnel
- D. Dust collection drum
- E. Drum window
- F. Drum caster

Connecting your cyclone separator to your dust collector you will need to run a dust hose from dust collector inlet to the cyclone separator's outlet. Then run a dust hose from inlet to machine dust port. Secure both hoses in place with hose clamps. Minimum air flow of 471CFM required.

**Warning!**

If you are not experienced with this type of machine, WE STRONGLY RECOMMEND that you seek additional training outside of this manual. Read books/magazines or get formal training before beginning any projects. (See figure 9)



Figure 9

**Operation**

## Maintenance

Dispose the collection drum bag when 3/4 full, as seen in the drum window.

<b>IMPORTANT:</b>
To contain wood dust and minimize risk of exposure, firmly tie bag closed. If bag gets overfilled, dust will be sucked into the intake barrel and passed through to the dust collector filter. Check the drum window regularly to prevent excessive dust buildup in collection drum.



## CX427 Cyclone Separator Parts Diagram

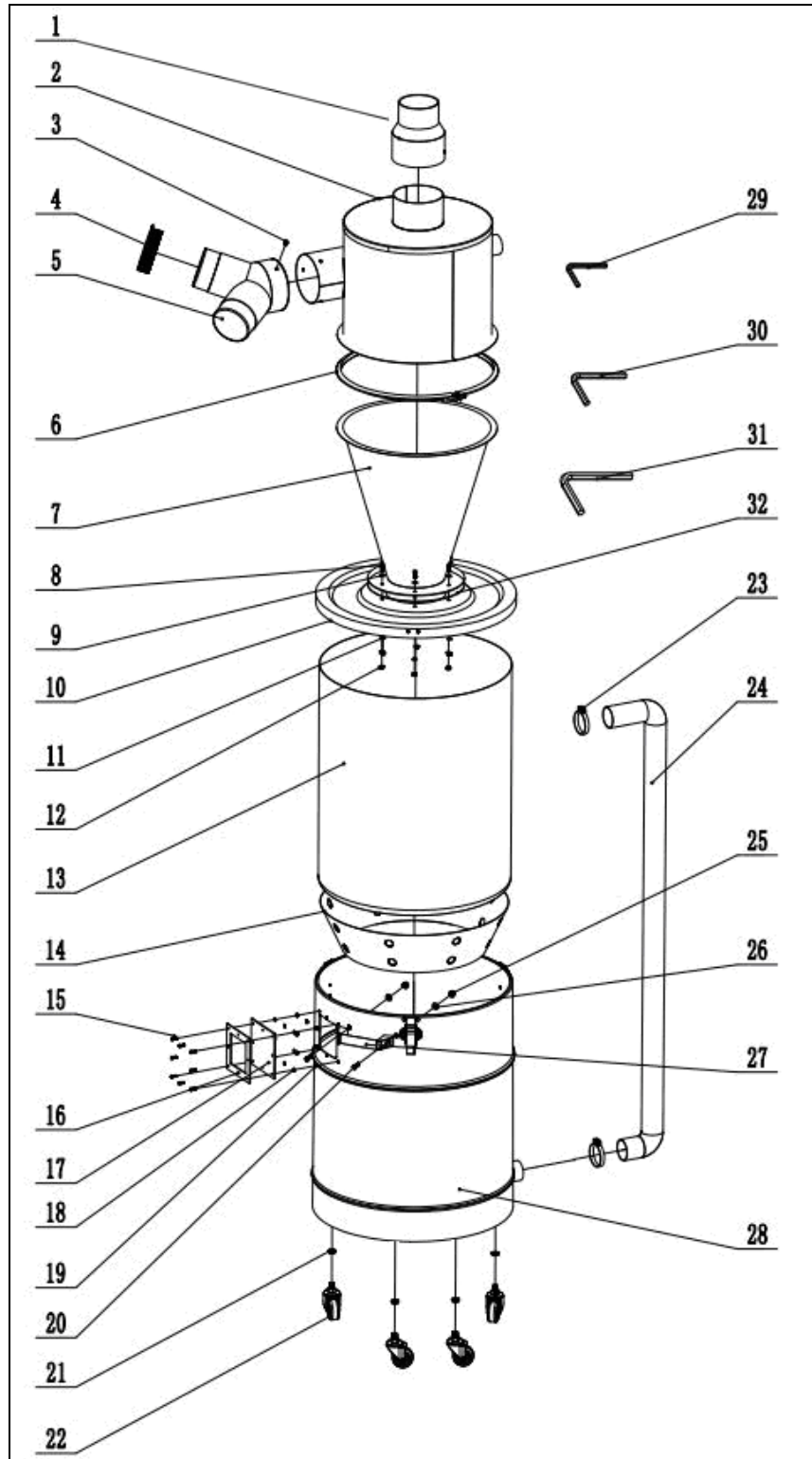

**CX427 Cyclone Separator**

KEY	ITEM	DESCRIPTION	QTY
1	PCX42701	OUTLET ADAPTOR	1
2	PCX42702	INTAKE BARREL	1
3	PCX42703	SCREW - M5-0.8 X 8	1
4	PCX42704	INLET APAPTOR CAP	1
5	PCX42705	INLET ADAPTOR	1
6	PCX42706	BAND CLAMP	1
7	PCX42707	CYCLONE FUNNEL	1
8	PCX42708	SCREW M6-1.0 X 15	6
9	PCX42709	WASHER - FLAT M6	6
10	PCX42710	DRUM LID	1
11	PCX42711	WASHER - FLAT M6	6
12	PCX42712	NUT - HEX M8-1.25	6
13	PCX42713	DRUM BAG	1
14	PCX42714	VACUUM RING	1
15	PCX42715	SCREW - M4-0.7 X 12	8
16	PCX42716	RUBBER GASKET	1
17	PCX42717	DRUM WINDOW	1
18	PCX42718	WASHER - FLAT M4	8
19	PCX42719	NUT - HEX M4-0.7	8
20	PCX42720	SCREW - M8-1.25 X 20	2
21	PCX42721	NUT - HEX M10-1.5	3
22	PCX42722	DRUM CASTER	3
23	PCX42723	HOSE CLAMP	2
24	PCX42724	VACUUM HOSE	1
25	PCX42725	NUT - NYLOCK M8-1.25	2
26	PCX42726	WASHER - FLAT M8	2
27	PCX42727	DRUM HANDLE	1
28	PCX42728	DUST COLLECTION DRUM	1
29	PCX42729	HEX WRENCH M4	1
30	PCX42730	HEX WRENCH M5	1
31	PCX42731	HEX WRENCH M6	1
32	PCX42732	RUBBER GASKET	1



### Craftex Machinery Warranty

Busy Bee Tools warrants every Craftex machine to be free from defects in materials and agrees to correct such defects where applicable. This warranty covers **two years** for Craftex machines and **three years** for Craftex CX-Series Machines and 90 days for labour (unless specified otherwise), to the original purchaser from the date of purchase but does not apply to malfunctions arising directly or indirectly from misuse, abuse, improper installation or assembly, negligence, accidents, repairs or alterations or lack of maintenance. *Proof of purchase is necessary.*

All warranty claims are subject to inspection of such products or part thereof and Busy Bee Tools reserves the right to inspect and all items before a refund or replacement may be issued. A Machinery Return Form must be filled out by the original purchaser requesting a return. Authorization may take up to 72 hours for inspection and approval.

This warranty shall not apply to consumable products such as blades, bits, belts, cutters, chisels, punches etc...

Busy Bee Tools shall in no event be liable for injuries, accidental or otherwise, death to persons or damage to property or for incidental contingent, special or consequential damages arising from the use of our products.

### RETURNS, REPAIRS AND REPLACEMENTS

To return, repair, or replace a Craftex Machine, a Machinery Return Form must be filled out by the original purchaser requesting a return. Visit the appropriate Busy Bee Tools showroom or call 1-800-461-BUSY. Craftex is a brand of equipment that is exclusive to Busy Bee Tools.

For replacement parts directly from Busy Bee Tools, for this machine, please call 1-800-461-BUSY (2879), and have your credit card and part number handy. You can find the part number in the back of your owners manual under the parts list & exploded diagram.

- All returned merchandise will be subject to a minimum charge of 15% for re-stocking and handling
- A Machinery Return Form must be filled out by the original purchaser requesting a return and it must be approved by Busy Bee Tools in writing before accepting a return
- We do not accept *collect* shipments.
- Items returned for warranty purposes must be insured and shipped pre-paid to the nearest warehouse
- Returns must be accompanied with a copy of your original invoice as proof of purchase. Incurred shipping and handling charges are not refundable.
- Busy Bee Tools will repair or replace the item at our discretion and subject to our inspection.
- Repaired or replaced items will be returned to you pre-paid by our choice of carriers.
- Busy Bee Tools reserves the right to refuse reimbursement or repairs or replacement if a third party without our prior authorization has carried out repairs to the item.
- Repairs made by Busy Bee Tools are warranted for 30 days on parts and labour.
- Any unforeseen repair charges will be reported to you for acceptance prior to making the repairs.
- Replacement motors purchased from Busy Bee Tools carry a 90 manufactures defect warranty
- The Busy Bee Tools Parts & Service Departments are fully equipped to do repairs on all products purchased from us with the exception of some products that require the return to their authorized repair depots. A Busy Bee Tools representative will provide you with the necessary information to have this done.