



CX501
6" x 48" BELT & 12" DISC SANDER
User Manual



TABLE OF CONTENTS

General Safety Instructions	3
Specific Safety Instructions.....	4
Features	5
Physical Features	6
Unpacking	7
Proper Grounding	7
ON/OFF Power Switch	8
Horizontal Sanding	8
Tilting the Tables	9
Removing the Sanding Belt	9
Installing the New Belt	10
Belt Tracking Adjustment.....	10
Stop Fence	10
Dust Collection	11
Installing Sanding Disc Paper.....	11
Test Run	12
Work-Piece Inspection.....	12
Maintenance	12
Troubleshooting.....	13
Parts Breakdown	14 & 15
Parts List	16 - 18
Warranty	19

GENERAL SAFETY INSTRUCTIONS

Extreme caution should be used when operating all power tools. Know your power tool, be familiar with its operation, read through the owner's manual and practice safe usage procedures at all times.

- ❖ **ALWAYS** read and understand the user manual before operating the machine.
- ❖ **CONNECT** your machine **ONLY** to the matched and specific power source.
- ❖ **ALWAYS** wear safety glasses respirators, hearing protection and safety shoes, when operating your machine.
- ❖ **DO NOT** wear loose clothing or jewelry when operating your machine.
- ❖ **A SAFE ENVIRONMENT** is important. Keep the area free of dust, dirt and other debris in the immediate vicinity of your machine.
- ❖ **BE ALERT! DO NOT** use prescription or other drugs that may affect your ability or judgment to safely use your machine.
- ❖ **DISCONNECT** the power source when changing drill bits, hollow chisels, router bits, shaper heads, blades, knives or making other adjustments or repairs.
- ❖ **NEVER** leave a tool unattended while it is in operation.
- ❖ **NEVER** reach over the table when the tool is in operation.
- ❖ **ALWAYS** keep blades, knives and bits sharpened and properly aligned.
- ❖ **ALL OPERATIONS MUST BE** performed with the guards in place to ensure safety.
- ❖ **ALWAYS** use push sticks and feather boards to safely feed your work through the machine.
- ❖ **ALWAYS** make sure that any tools used for adjustments are removed before operating the machine.
- ❖ **ALWAYS** keep the bystanders safely away while the machine is in operation.

CX501 – 6”x48” Belt & 12” Disc Sander

SPECIFIC SAFETY INSTRUCTIONS

- ⚠ **MAKE SURE** the sander is connected to the matched and specific power source instructed in the manual.
- ⚠ **ALL THE GUARDS** must be in place while operating the sander to ensure safety.
- ⚠ **MAKE SURE** before making any adjustments, the switch is in the “OFF” position and the cord is un-plugged from the power source.
- ⚠ **NEVER** sand more than one work piece at a time.
- ⚠ **DO NOT** wear loose clothing while operating this sander.
- ⚠ **KEEP YOUR WORK AREA CLEAN.** Cluttered areas and workbenches increase the chance of accident.
- ⚠ **NEVER LEAVE** the sander unattended while it is running.
- ⚠ **KEEP CHILDREN AWAY.** All visitors should be kept at a safe distance from the work area.
- ⚠ **DO NOT** force the sander. It will do the job better and will be safer at the operating rate for which it is designed.
- ⚠ **ALWAYS** wear a dust mask and safety glasses while operating the sander. The tiny dust particles produced by the sander can cause serious health problems.
- ⚠ **ALWAYS** inspect stock for staples, nails knots or any other foreign material before sanding.
- ⚠ **ALWAYS** operate the sander in a well-ventilated area and use a dust collection system for dust removal whenever possible.
- ⚠ **ALWAYS** hold the work piece firmly when sanding. When not using the table, i.e. sanding free-hand, grip the work piece with both hands.
- ⚠ **USE THE STOP FENCE** when performing horizontal sanding on the belt sander.
- ⚠ **MAINTAIN AND SERVICE** your sander regularly as instructed in the user manual.
- ⚠ **MAKE SURE** you have read and understood all the safety instructions in the manual and you are familiar with your CX501 sander, before operating it. If you fail to do so, serious injury could occur.

WARNING

The safety instructions given above can not be complete because the environment in every shop is different. Always consider safety first as it applies to your individual working conditions.



CX501 – 6”x48” Belt & 12” Disc Sander

FEATURES

MODEL CX501 – 6” x 48” BELT & 12” DISC SANDER

As part of the growing line of Crafttex woodworking equipment, we are proud to offer CX501a 6” x 48” Belt and 12” Disc Sander. The Crafttex name guarantees Craft Excellence. By following the instructions and procedures laid out in this user manual, you will receive years of excellent service and satisfaction. The CX501 is a professional tool and like all power tools, proper care and safety procedures should be adhered to.

- ❖ Belt sander operates horizontally & vertically and can be locked at any angle in between
- ❖ Belt tracking adjustments are easily made with thumb screws
- ❖ Two dust ports; 2” & 2-3/8” and two precision aluminum tables with miter gauge slots
- ❖ Powdered coated paint
- ❖ Motor 1 1/2-HP, 60-HZ, 1720-RPM
- ❖ Disc Diameter 12”
- ❖ Disc Table Size..... 17.5” x 10”
- ❖ Disc Table Tilt..... 0° to -45°
- ❖ Belt Size 6” Width x 48” Length
- ❖ Belt Speed 2500 SFPM
- ❖ Belt Sander Tilt 0° to 90°
- ❖ Belt Table Size 10” x 8”
- ❖ Belt Table Tilt..... 0° to -45°
- ❖ Approx Weight 60.5 Kgs
- ❖ Warranty 3 Years

CX501 – 6"x48" Belt & 12" Disc Sander PHYSICAL FEATURES

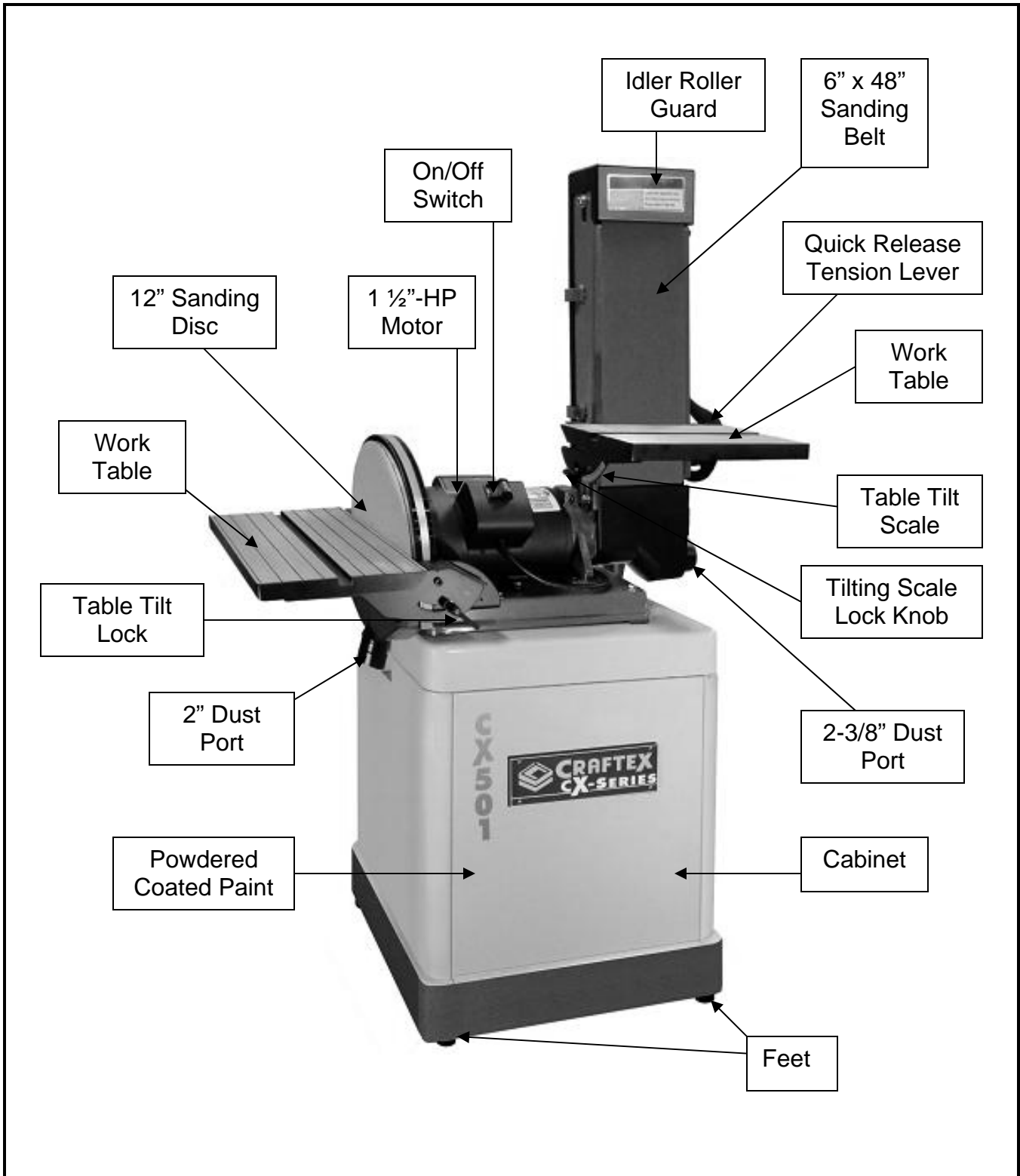

UNPACKING

The machine is properly packaged and is shipped completely in a crate for safe transportation. When unpacking, carefully inspect the crate and ensure that nothing has been damaged during transit. Open the crate and check that the machine is in good condition.

WARNING

CX501 is a very heavy machine, do not over-exert yourself. For safe moving method use fork truck or get the help of an assistant or friend.

PROPER GROUNDING

Grounding provides a path of least resistance for electric current to reduce the risk of electric shock.

CX501 is equipped with a 120 volt single phase motor which features a 3-conductor cord and a 3-prong grounded plug to fit a grounded type receptacle. Make sure the cord is plugged into a properly installed and grounded power outlet.

To prevent electrical hazards, have a qualified electrician ensure that the line is properly wired.

This appliance is for use on a normal 120-volt circuit and is factory-equipped with a specific electric cord and plug to permit connection to a proper electric circuit. Make sure that the appliance is connected to an outlet having the same configuration as the plug. If an adaptor plug is used, it must be attached to the metal screw of the receptacle.

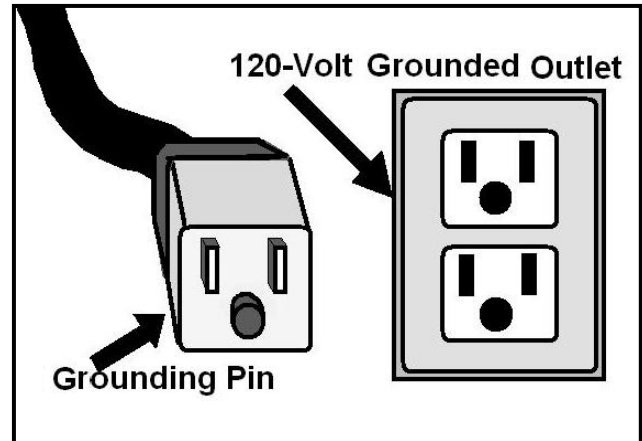

Figure-1 120-Volts Outlet for CX501

WARNING

Improper connection of the equipment-grounding conductor can result in a risk of electric shock. Check with a qualified electrician if you are in doubt as to whether the outlet is properly grounded.

It is strongly recommended not to use extension cords with your CX501. Always try to position your machine close to the power source so that you do not need to use extension cords.

In case if you really find it necessary to use an extension cord, make sure the extension cord does not exceed 50-feet in length and the cord is 14-gauge to prevent motor damage.

Your CX501 is equipped with a cord having 3-prongs which fits a 3 prong grounding receptacle as shown in figure-3. Do not remove the grounding prong to fit it into a 2-pronged outlet. Always check with a qualified electrician if you are in doubt.

ON/OFF POWER SWITCH

CX501 is equipped with a rocker-type power switch which starts and stops the motor and is located on the junction box of the motor. The switch features a removable locking key to prevent unauthorized operations. When the sander is not in use for a long period of time, simply remove the locking key and store it in a safe place.

To start the sander, insert the locking key and shift the switch to the left.

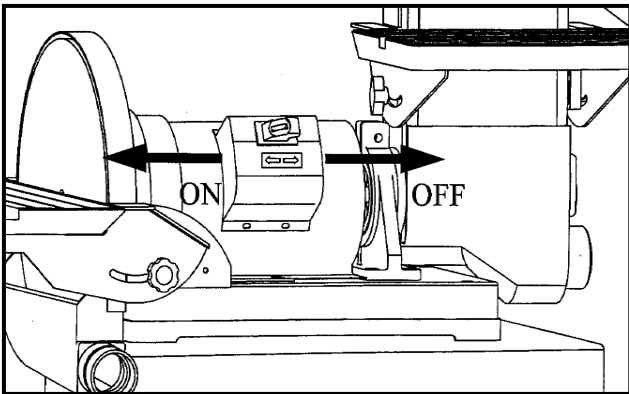

Figure-2 On/Off Switch

IMPORTANT

To prevent any type of accidental injuries, make sure the power switch is in the OFF position before connecting the sander to the power source.

HORIZONTAL/VERTICAL SANDING

1. Loosen the screw securing the sander frame to the motor bracket using a 6 mm hexagonal wrench.

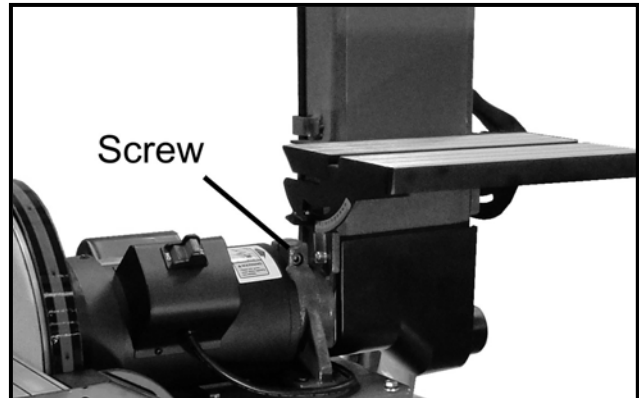

Figure-3 Removing the screw

2. Remove the belt sander table.
3. Move the belt sander to horizontal / vertical position manually.
4. Tighten the screw securely after the belt sander has been positioned horizontally / vertically.

Make sure to mount the stop fence as shown in figure-4 when performing flat surface sanding.

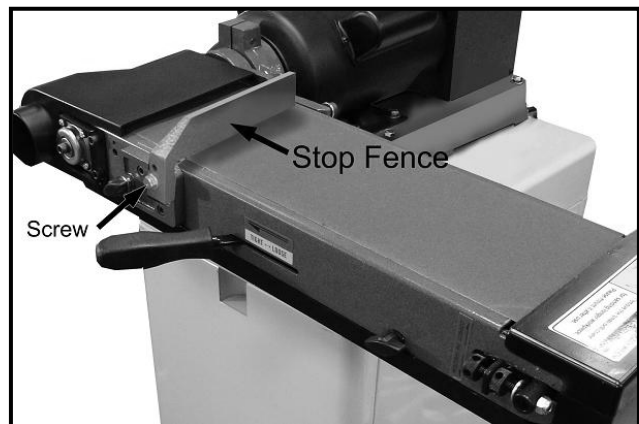

Figure-4 Installing stop fence

TILTING THE TABLES

Both tables on CX501 sander can be tilted from 0° to 45°.

To tilt the tables:

1. Loosen the table levers/knobs securing the tables to the sander frame, located under the right and left sides of each table.

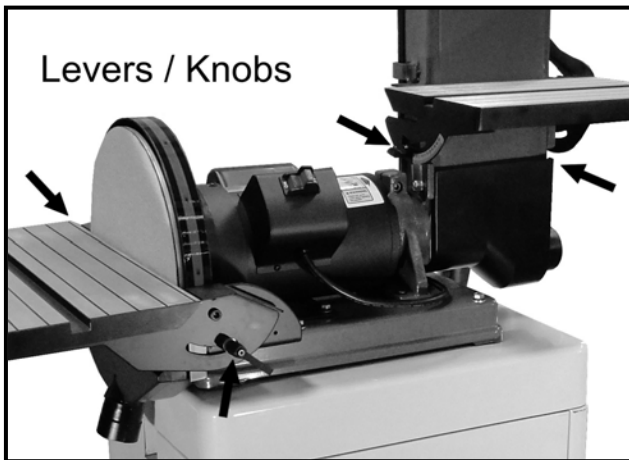

Figure-5 Loosening the levers/knobs

2. Adjust the tables tilt position according to the graduated scales attached for indicating the tilting degree of the tables.
3. Retighten the levers/knobs securely.

REMOVING THE SANDING BELT

1. Turn off the sander and disconnect the cord from the power source.
2. Loosen the 5 lock knobs securing the belt guard and remove it. See figure-6

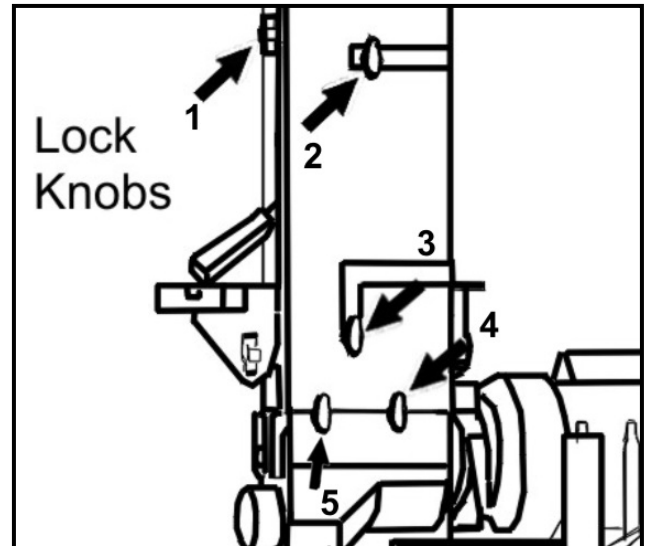

Figure-6 Lock knobs to be loosened

3. Loosen the two table lock levers and the two screws holding the table to the sander and remove the table.
4. Remove the table-tilt graduated scale.
5. Loosen the belt tension by shifting the belt tension control lever upward.

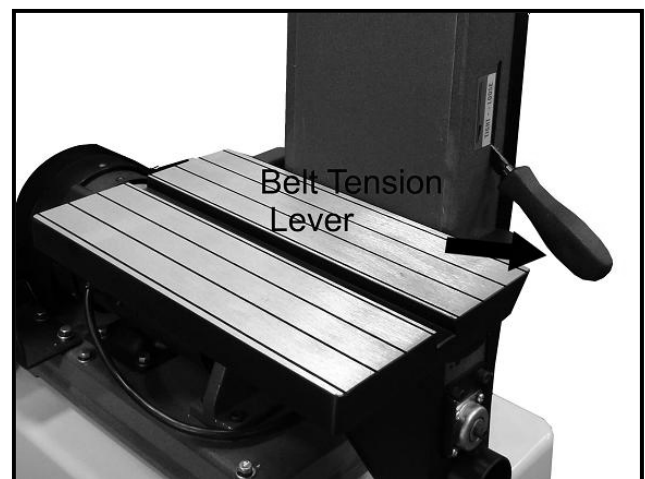

Figure-7 Releasing the belt tension

6. Remove the sanding belt from the right side.

INSTALLING NEW BELT

After the old belt has been removed proceed as follows:

1. Make sure the arrowheads marked on the back of the sanding belt point to the direction indicator attached on the belt guard.
2. Place and center the new belt on both the rollers.
3. Tighten the belt tension by shifting the belt tension control lever downwards.
4. Install the tilt scale, the table and the belt guard back.

BELT TRACKING ADJUSTMENT

Belt tracking means where the belt rides on the rollers. The belt should always be centered on both the rollers.

To adjust the sanding belt tracking:

1. Turn the sander on for 2 or 3 seconds and see if the belt wanders to the left or right.

If the sanding belt is not riding the rollers on a centered path, adjustment is necessary.

2. Turn off the sander and disconnect the cord from the power source.
3. Loosen the “fix nut” shown in figure-8.

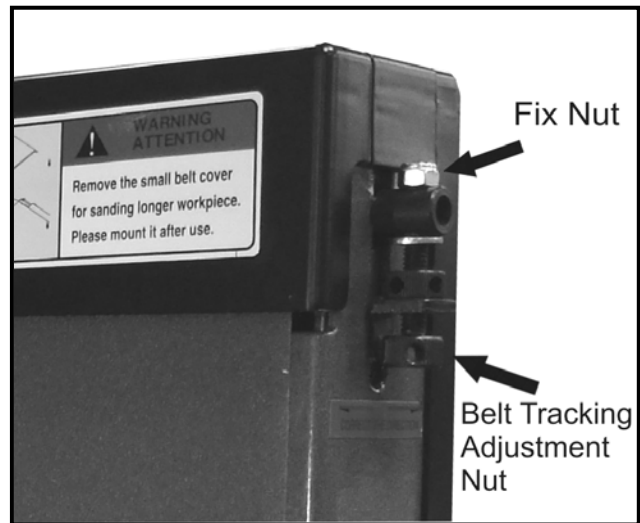

Figure-8 Belt Tracking adjustment

4. Check if the sanding belt is tracking forward or backward. Turn the adjustment nut (shown in figure-8) counter-clockwise to move the belt forward. Turn the adjustment nut clockwise to move the belt backwards.
5. Connect the machine to the power source and turn it on. Observe the blade tracking on the rollers.

If the blade is tracking in the center, the adjustment is properly done.

If the belt is still not tracking in the center, repeat from step 3 to 5.

STOP FENCE

When the sanding platen is set for horizontal sanding, the stop fence should be used to prevent the work piece flying out while sanding.

Install the stop fence to the sanding platen using the two lock knobs.

DUST COLLECTION

CX501 features two dust ports; 2" & 2-3/8" to connect to a dust collector.

When connecting to a dust collector, use a proper sized hose and make sure all the connections are sealed tightly.

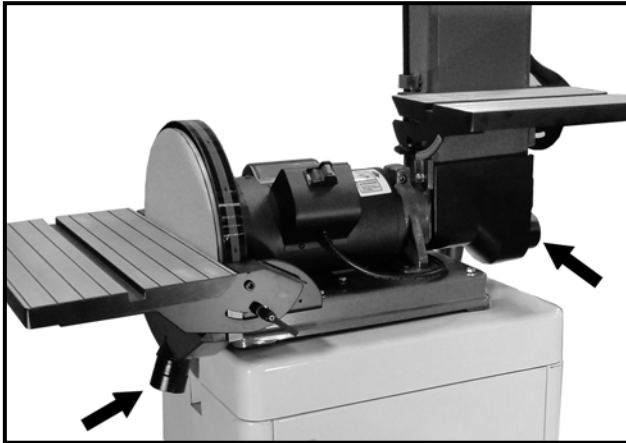

Figure-9 Dust ports

INSTALLING SANDING DISC PAPER

CX501 features a 12" sanding disc.

Remove the disc table by loosening the screws securing it to the sander and remove the old sanding paper.

For easy sanding disc installation and removal, the 12" disc features Velcro pad and accepts sanding papers with Velcro backing.

When installing the disc, simply attach the Velcro backing sand paper to the disc and press it to make sure the sanding paper is properly attached.

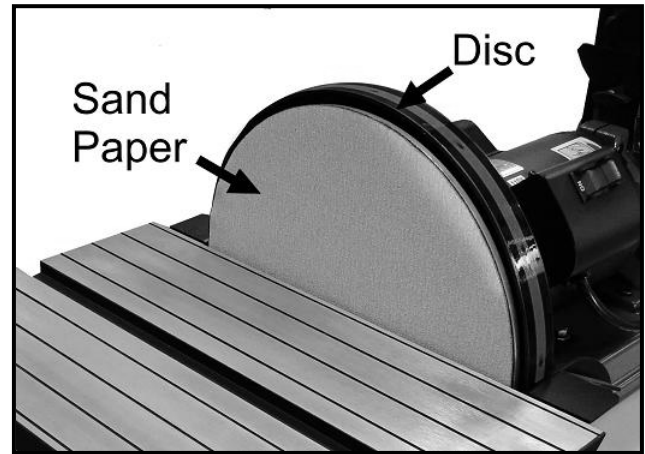

Figure-10 Installing the sand paper

IMPORTANT

Make sure you have done the tracking adjustment and the belt is centered on both the rollers before you start the sander for a test run. See page-10 for details on belt tracking.

TEST RUN

Once you have assembled your machine completely, it is then time for a test run to make sure that the machine works properly and is ready for operation.

During the test run if there is any unusual noise coming from the machine or the machine vibrates excessively, stop the machine immediately and disconnect from the power source and troubleshoot to determine the problem with your machine. See page-13 for Troubleshooting.



**READ THE
MANUAL**

Before starting the sander, make sure that you have read and understood the manual and you are familiar with the functions and safety features on this machine. Failure to do so may cause serious personal injury.

WORK-PIECE INSPECTION

CX501 is designed to sand wood **ONLY**. Do not use this machine to sand metals, glass or stone etc.

Before sanding, make sure to inspect the work-piece for nails, staples, small pieces of stone or metal and any other foreign objects.

Sanding the work-piece with this kind of objects can tear the sanding paper. For a

safe cutting method always inspect your work-piece carefully before cut and wear eye protection.

Some woods with excessive finish or glue load up the sand paper and reduce its usefulness. Use an abrasive cleaner to clean the sanding paper.

Abrasive Cleaners

Model# 15154

Model# 15158



MAINTENANCE

1. Clean the machine daily after use.
2. When the machine is not in use, turn the switch off and remove the switch key.
3. A build-up of dust in the motor can cause motor damage. Periodic cleaning of the motor is not only recommended, but also mandatory for normal sander performance.
4. Keep the machine and attachments clean.
5. All bearings are permanently lubricated and require no further lubrication.

TROUBLESHOOTING

PROBLEM	CAUSES	SOLUTION
Motor does not run when power switch is turned ON.	<ol style="list-style-type: none"> 1. Switch is burnt out. 2. Connection wire is loose or damaged. 	<ol style="list-style-type: none"> 1. Replace the switch. 2. Tighten or replace the wire.
Motor does not run at full speed.	<ol style="list-style-type: none"> 1. Power voltage is too low. 2. Motor is damaged. 	<ol style="list-style-type: none"> 1. Test voltage. 2. Check and repair motor.
Machine does not reach full power.	<ol style="list-style-type: none"> 1. Incorrect power wiring 2. Overload 	<ol style="list-style-type: none"> 1. Replace with the correct wire size. 2. Reduce sanding load.
Motor over heating	<ol style="list-style-type: none"> 1. Motor is dirty. 2. Motor is damaged 	<ol style="list-style-type: none"> 1. Clean motor. 2. Check and repair motor.
Excessive machine vibration	<ol style="list-style-type: none"> 1. Machine is incorrectly levelled. 	<ol style="list-style-type: none"> 1. Adjust machine levelling.

CX501 PARTS BREAKDOWN

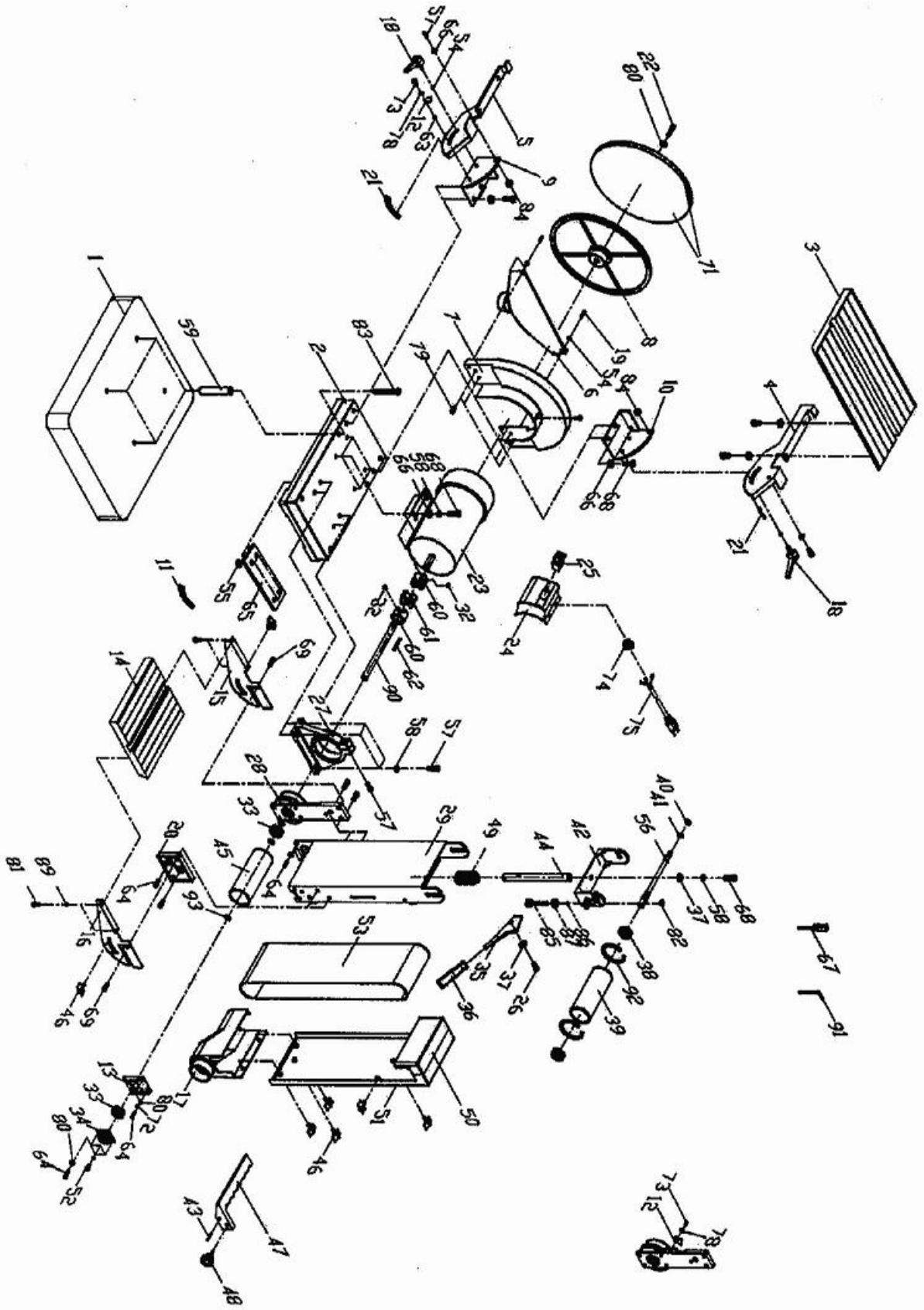

CX501 PARTS BREAKDOWN

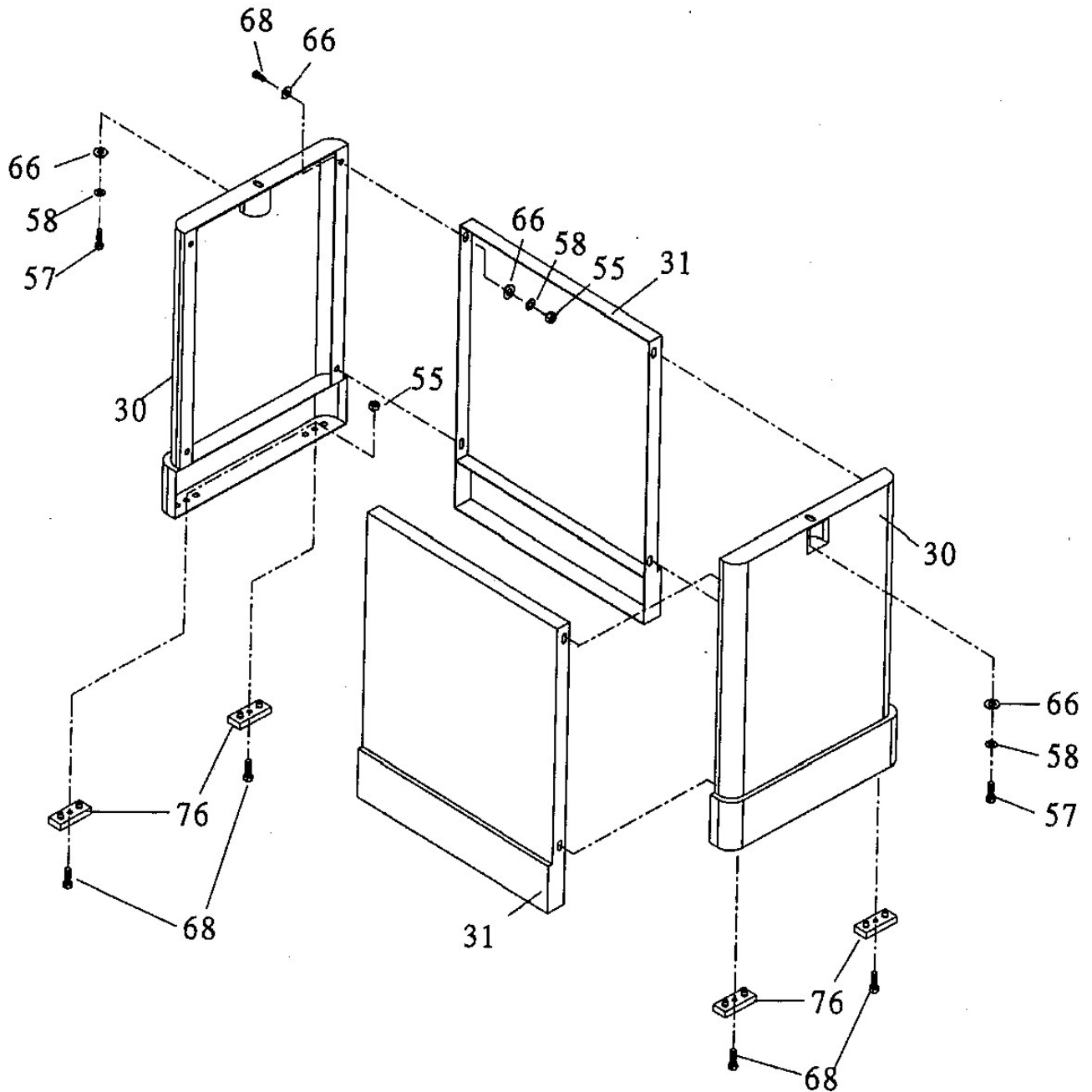

CX501 PARTS LIST

REF#	DESCRIPTION	QTY
1	LOWER BASE	1
2	UPPER BASE	1
3	12" WORKING TABLE	1
4	FRONT GRADUATED SCALE	1
5	REAR GRADUATED SCALE	1
6	12" DUST HOOD	1
7	DISC GUARD	1
8	DISC PLATE	1
9	FRONT BRACKET	1
10	REAR BARACKET	1
11	GRADUATED SCALE	1
12	INDICATOR	1
13	BEARING FIX PLATE	1
14	TABLE	1
15	AUXILIARY LEFT SCALE PLATE	1
16	AUXILIARY RIGHT SCALE PLATE	1
17	DUST HOOD	1
18	LOCKING LEVER	2
19	LONG SPACER	1
20	RIGHT GRADUATED SCALE	1
21	GRADUATED SCALE	1
22	M6X15L LEFT SCREW	1
23	MOTOR	1
24	SWITCH BOX	1
25	SWITCH	1
26	SCREW 5/16"X1-1/2"L	1
27	TILTING FIX BRACKET	1
28	CONNECTION BLOCK	1
29	SANDING PLATEN	1
30	RIGHT & LEFT BRACKET	2
31	FRONT & REAR SPACING PLATE	2
32	1/4"-24 UNC x 1/4" SOC-SET SCREW	1

CX501 PARTS LIST

REF#	DESCRIPTION	QTY
33	BEARING 6202	1
34	BEARING CAP 6202	1
35	BELT CHANGEHANDLE	1
36	HANDLE KNOB	1
37	FLAT WASHER 5/16"	2
38	BEARING 6201	2
39	IDLER ROLLER	1
40	NYL ON NUT 1/4"	1
41	" C " CIRCLIP STW-12	1
42	IDLER ROLLER BRACKET	1
43	SPRING PIN 4 × 16	1
44	BRACKET SHAFT	1
45	DRIVE ROLLER	1
46	LOCK KNOB	5
47	STOP FENCE	1
48	SCREW	1
49	SPRING	1
50	DUST GUARD A	1
51	DUST GUARD BASE	1
52	ROUND CROSS HEAD SCREW 3/16" × 1/4"	4
53	SANDING BELT 6×48"	1
54	FLAT WASHER 5X12	4
55	1/4" -20 UNC NUT	1
56	IDLER ROLLER SHAFT	1
57	CAP SCREW 5/16"-18UNC × 1"	7
58	SPING WASHER 5/16 "	21
59	LONG SPACED RING	4
60	COUPLER	2
61	COMPOUND BLOCK	1
62	KEY 5 × 5 × 30	1
63	UP SPACED RING	4
64	HEX A GONAL SOCKET HEAD SCREW 1/4" × 1/2"	7

CX501 PARTS LIST

REF#	DESCRIPTION	QTY
65	PLATE	1
66	FLAT WASHER	38
67	SCREWDRIVER	1
68	HEX SCREW 5/16"-18UNC × 1"	20
69	CAP 5/16"-18UNC-1/2"	2
70		
71	SANDING PAPER	1
72	SPRING WASHER 1/4"	8
73	SCREW 3/16"-24UNC × 5/8"	2
74	STRAIN RELIEF BUSHING	1
75	POWER CORD	1
76	PAD	4
77	SCREW 1/4"-20UNC × 1"	4
78	GEAR WASHER 1/4"	2
79	LOCKING NUT 5/16"-18UNC	5
80	1/4"X16	8
81	SCREW 3/16"-24UNC × 1/2"	6
82	NYL ON NUT 3/16"	2
83	HEX SCREW 5/16"-18UNC × 3"	4
84	NUT 5/16"	2
85	MICRO METRIC ADJUSTMENT SCREW	1
86	STEEL BALL	1
87	MICRO METRIC NUT	1
88	CARTON	1
89	POLYLON	1
90	COUPLED AXLE	1
91	HEX WRENCH 6mm	1
92	RTW-32 C" CIRCLIP	2
93	STW-15 C" CIRCLIP	3
94	MANUAL	1



WARRANTY

CRAFTEX 3 YEARS LIMITED WARRANTY

Craftex warrants every product to be free from defects in materials and agrees to correct such defects where applicable. This warranty covers **three years** for parts and 90 days for labour (unless specified otherwise), to the original purchaser from the date of purchase but does not apply to malfunctions arising directly or indirectly from misuse, abuse, improper installation or assembly, negligence, accidents, repairs or alterations or lack of maintenance.

Proof of purchase is necessary.

All warranty claims are subject to inspection of such products or part thereof and Craftex reserves the right to inspect any returned item before a refund or replacement may be issued.

This warranty shall not apply to consumable products such as blades, bits, belts, cutters, chisels, punches etceteras.

Craftex shall in no event be liable for injuries, accidental or otherwise, death to persons or damage to property or for incidental contingent, special or consequential damages arising from the use of our products.

RETURNS, REPAIRS AND REPLACEMENTS

To return, repair, or replace a Craftex product, you must visit the appropriate Busy Bee Tools showroom or call 1-800-461-BUSY. Craftex is a brand of equipment that is exclusive to Busy Bee Tools.

For replacement parts directly from Busy Bee Tools, for this machine, please call 1-800-461-BUSY (2879), and have your credit card and part number handy.

- All returned merchandise will be subject to a minimum charge of 15% for re-stocking and handling with the following qualifications.
- Returns must be pre-authorized by us in writing.
- We do not accept *collect* shipments.
- Items returned for warranty purposes must be insured and shipped pre-paid to the nearest warehouse
- Returns must be accompanied with a copy of your original invoice as proof of purchase. Returns must be in an un-used condition and shipped in their original packaging a letter explaining your reason for the return. Incurred shipping and handling charges are not refundable.
- Busy Bee will repair or replace the item at our discretion and subject to our inspection.
- Repaired or replaced items will be returned to you pre-paid by our choice of carriers.
- Busy Bee reserves the right to refuse reimbursement or repairs or replacement if a third party without our prior authorization has carried out repairs to the item.
- Repairs made by Busy Bee are warranted for 30 days on parts and labour.
- Any unforeseen repair charges will be reported to you for acceptance prior to making the repairs.
- The Busy Bee Parts & Service Departments are fully equipped to do repairs on all products purchased from us with the exception of some products that require the return to their authorized repair depots. A Busy Bee representative will provide you with the necessary information to have this done.
- For faster service it is advisable to contact the nearest Busy Bee location for parts availability prior to bringing your product in for repair.