



MODEL CX704MA MILLING ATTACHMENT USER MANUAL



STEP - 1

Move the cross slide to the right side and loosen the screws securing the swivel base to the saddle shown in figure below.



STEP - 2

Remove the swivel base and the top slide as shown in figure below.



STEP - 3

Align the holes on the CX704MA Milling Attachment base with the holes on the cross slide and secure the CX704MA Milling Attachment to the cross slide using screws.



PARTS BREAKDOWN

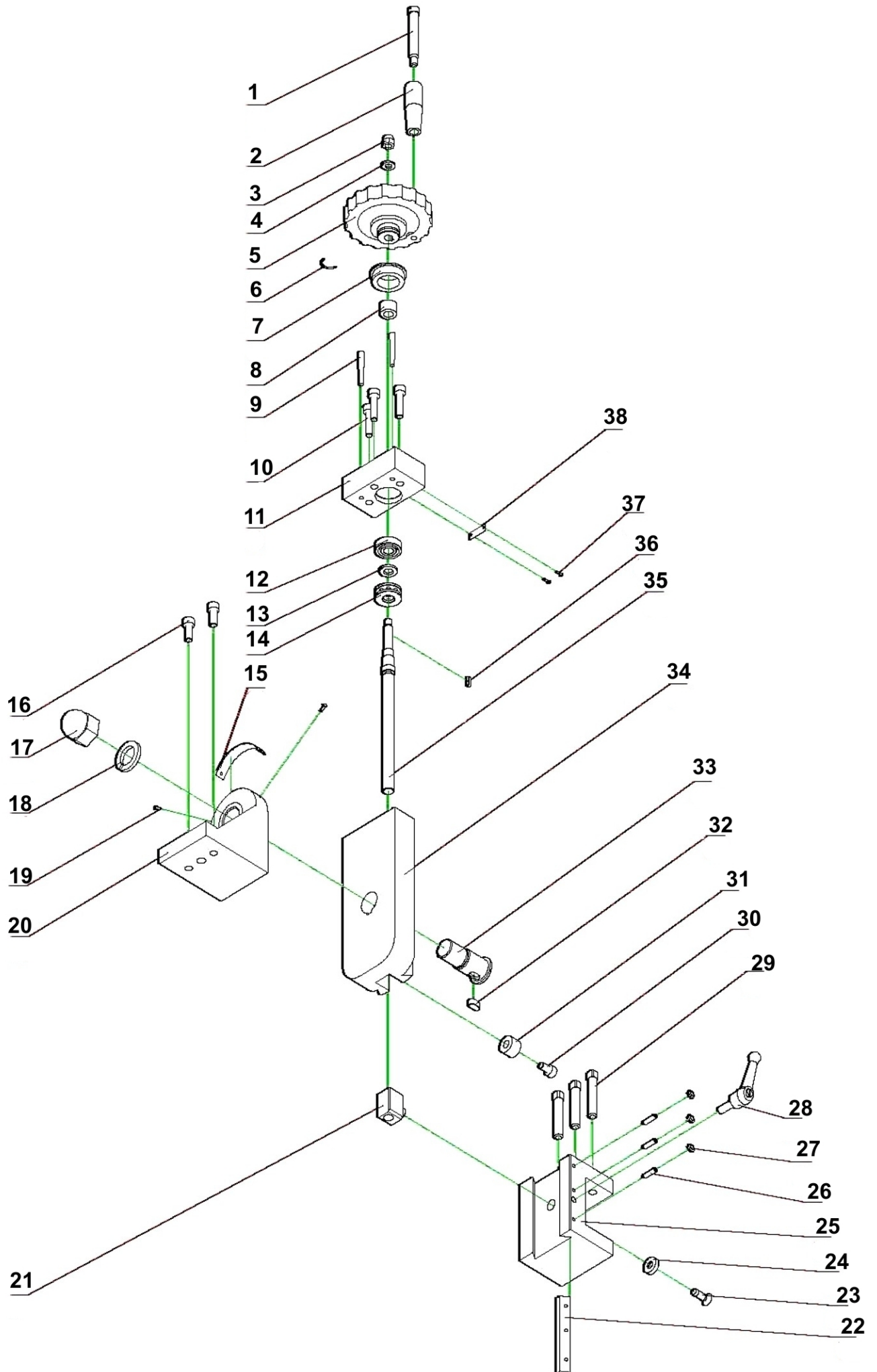

PARTS LIST

No.	Description	Quantity
1	Handle Bolt	1
2	Handle Sleeve	1
3	Nut	1
4	Flat washer	1
5	Handle	1
6	Spring steel	1
7	Graduated collar	1
8	Spacer II	1
9	Pin	2
10	Screw	3
11	Leadscrew support	1
12	Bearing	1
13	Spacer I	1
14	Bearing	1
15	Ruler	1
16	Screw	2
17	Nut	1
18	Spring washer	1
19	Label rivet	2
20	Bracket	1
21	Screw nut	1
22	Wedge	1
23	Screw	1
24	Shim	1
25	Slide block	1
26	Screw	3
27	Nut	3
28	Handle	1
29	Screw	3
30	Screw	1
31	Upper end washer	1
32	Key	1
33	Rotor shaft	1
34	rest lead rail	1
35	Feeding screw	1
36	Key	1
37	Label rivet	2
38	Label	1