

Please read the product instruction carefully and use the product correctly under the instruction

COMPONENT

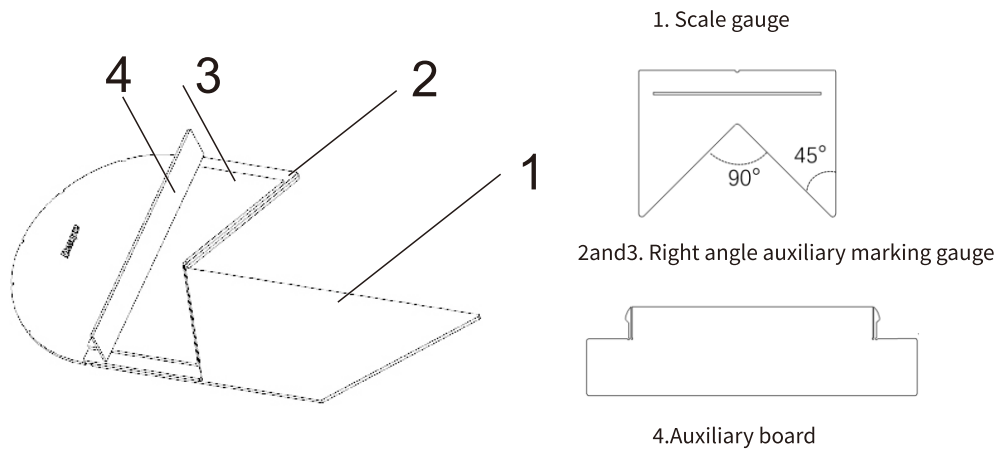

ASSEMBLE

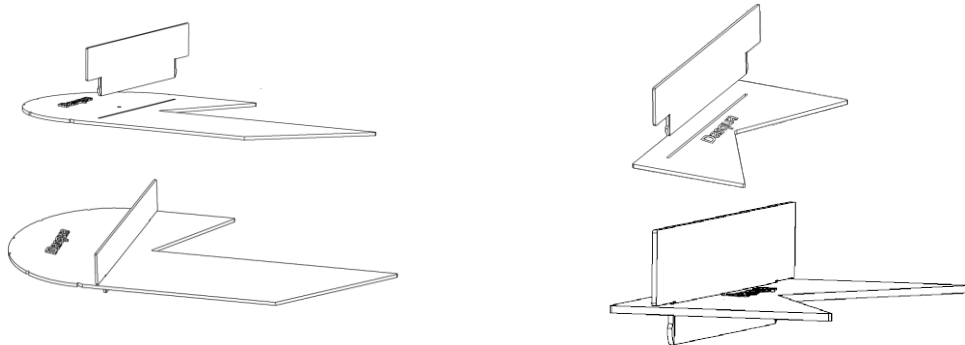

According to the direction and angle of I to be used, perpendicular to the scribing gauge, insert Auxiliary board into the rectangular hole of the scribing gauge, and make the buckle lock Auxiliary board and the scribing gauge

Drawing angle

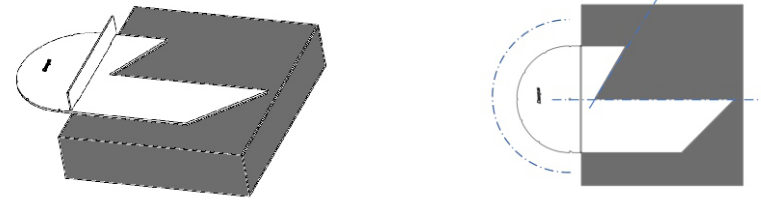

Drawing right angle

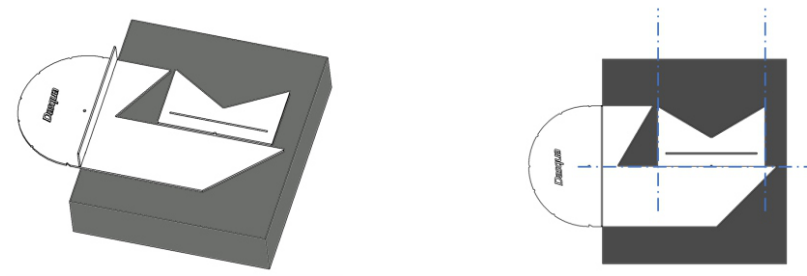

Drawing parallel line



Center line

